

BENETTI BNOW 50M
OASIS DECK
2023

€ 38,000,000 EX VAT

HAND OVER: 15.08.2023



External



External



External



External



External

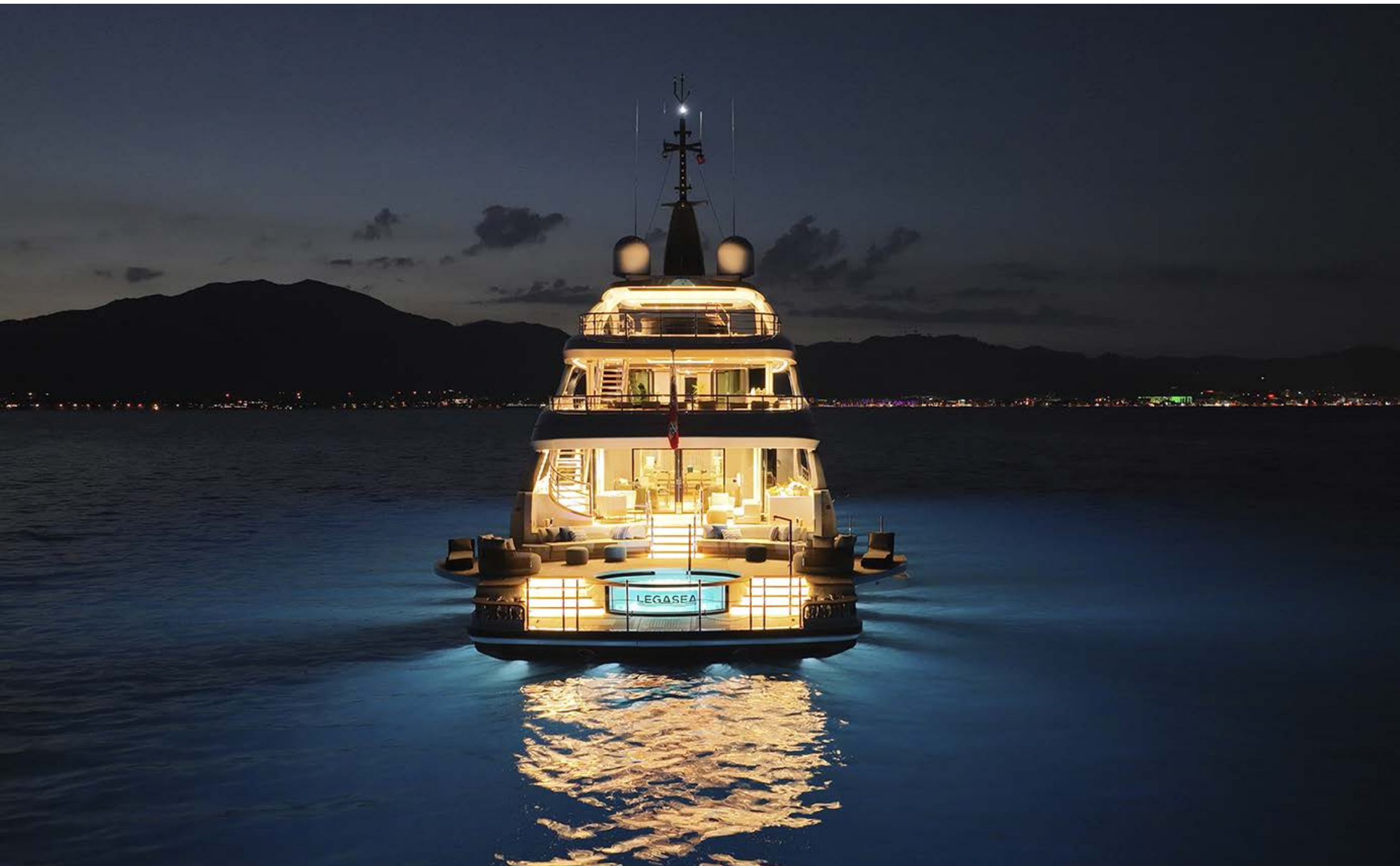

External



External



External



Bow



Sun Deck



Sun Deck



Sun Deck



Sun Deck



Sun Deck



Sun Deck



Sun Deck

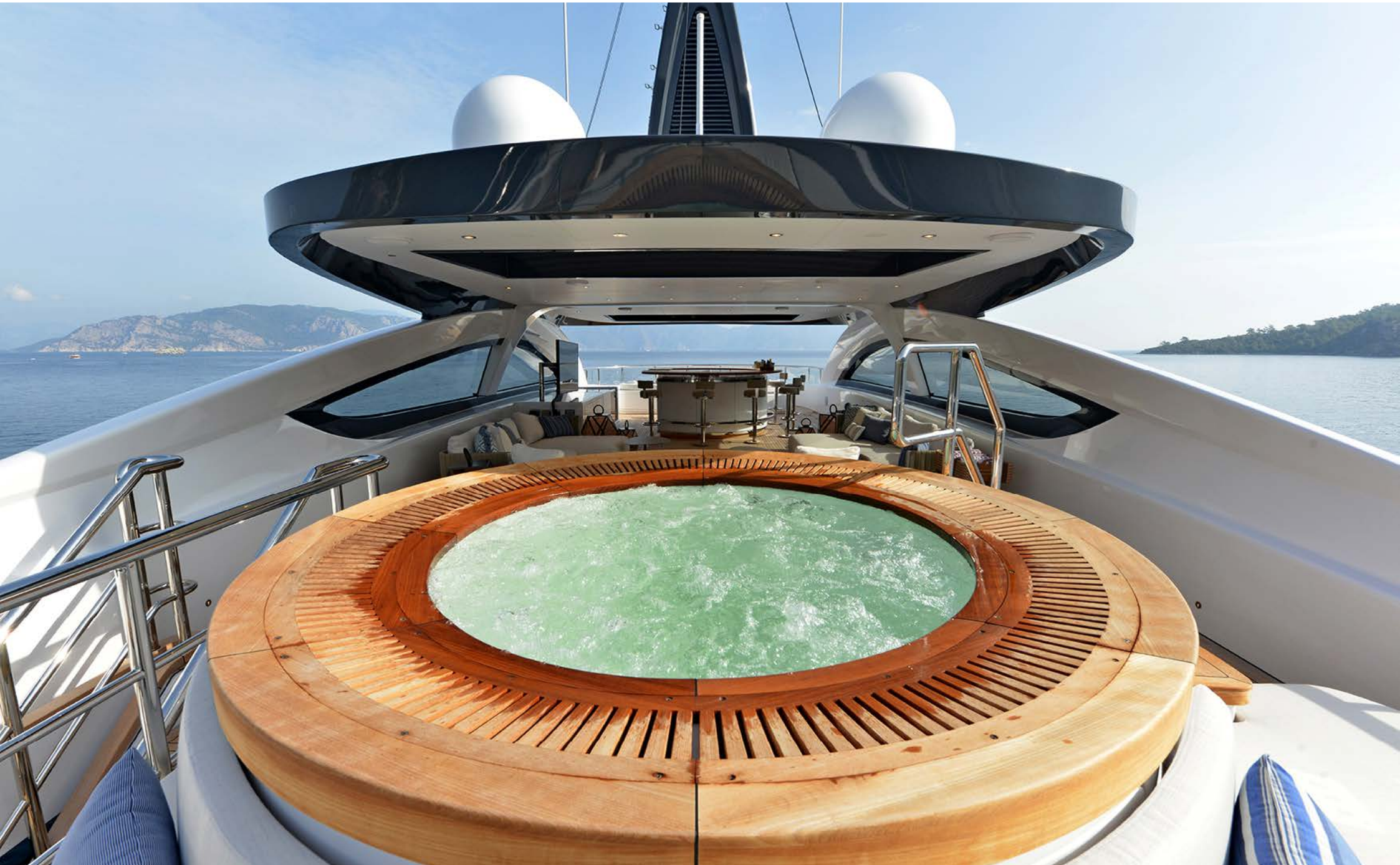

Sun Deck



Upper Deck

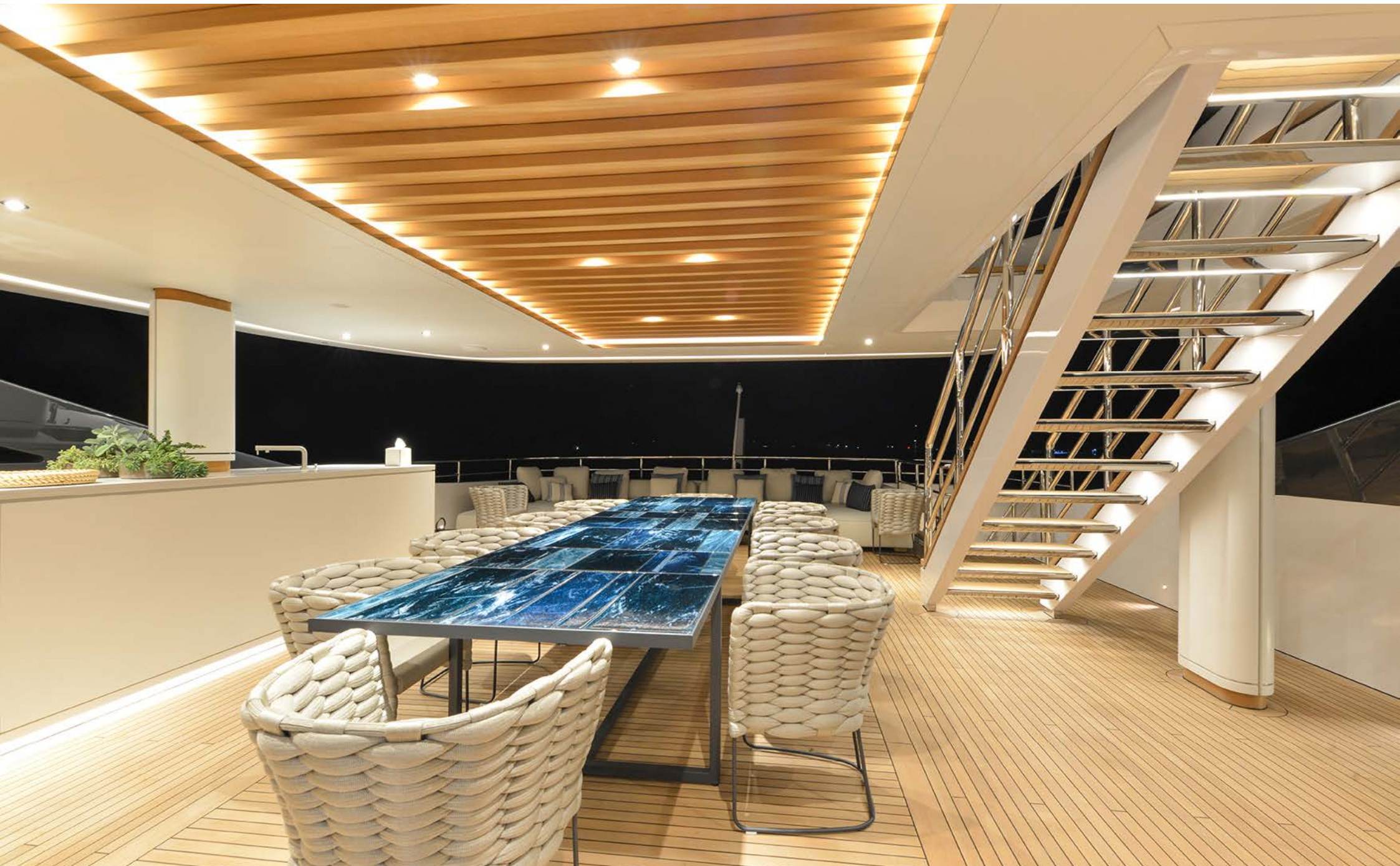

Upper Deck

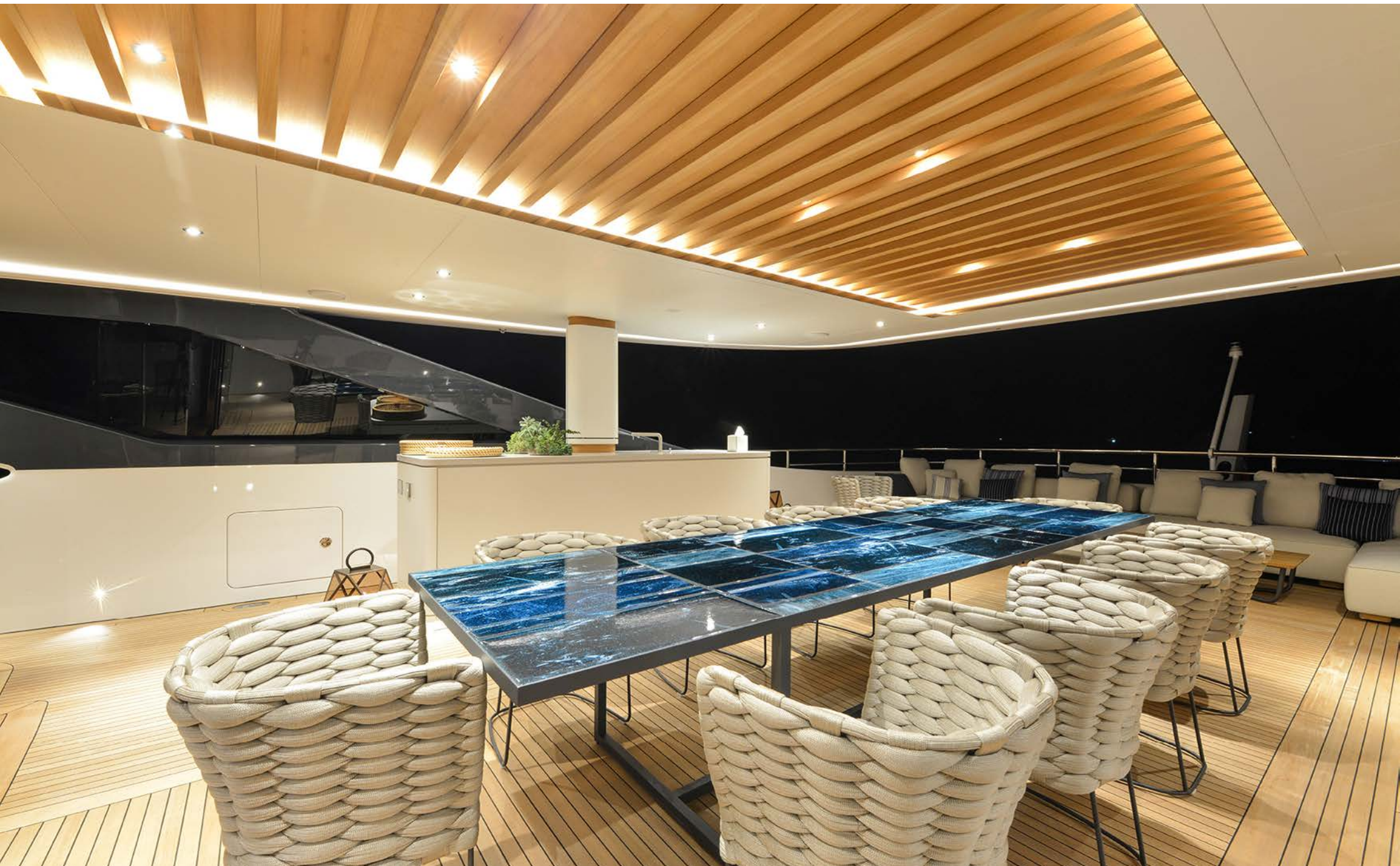

Upper Deck



Upper Deck



Upper Deck



Upeer Lounge



Upeer Lounge



Upeer Lounge



Bridge



Bridge



Main Saloon & Dining Area



Main Saloon & Dining Area



— Main Saloon & Dining Area —



Main Saloon & Dining Area



— Main Saloon & Dining Area —



Cockpit



Cockpit



Cockpit



Cockpit

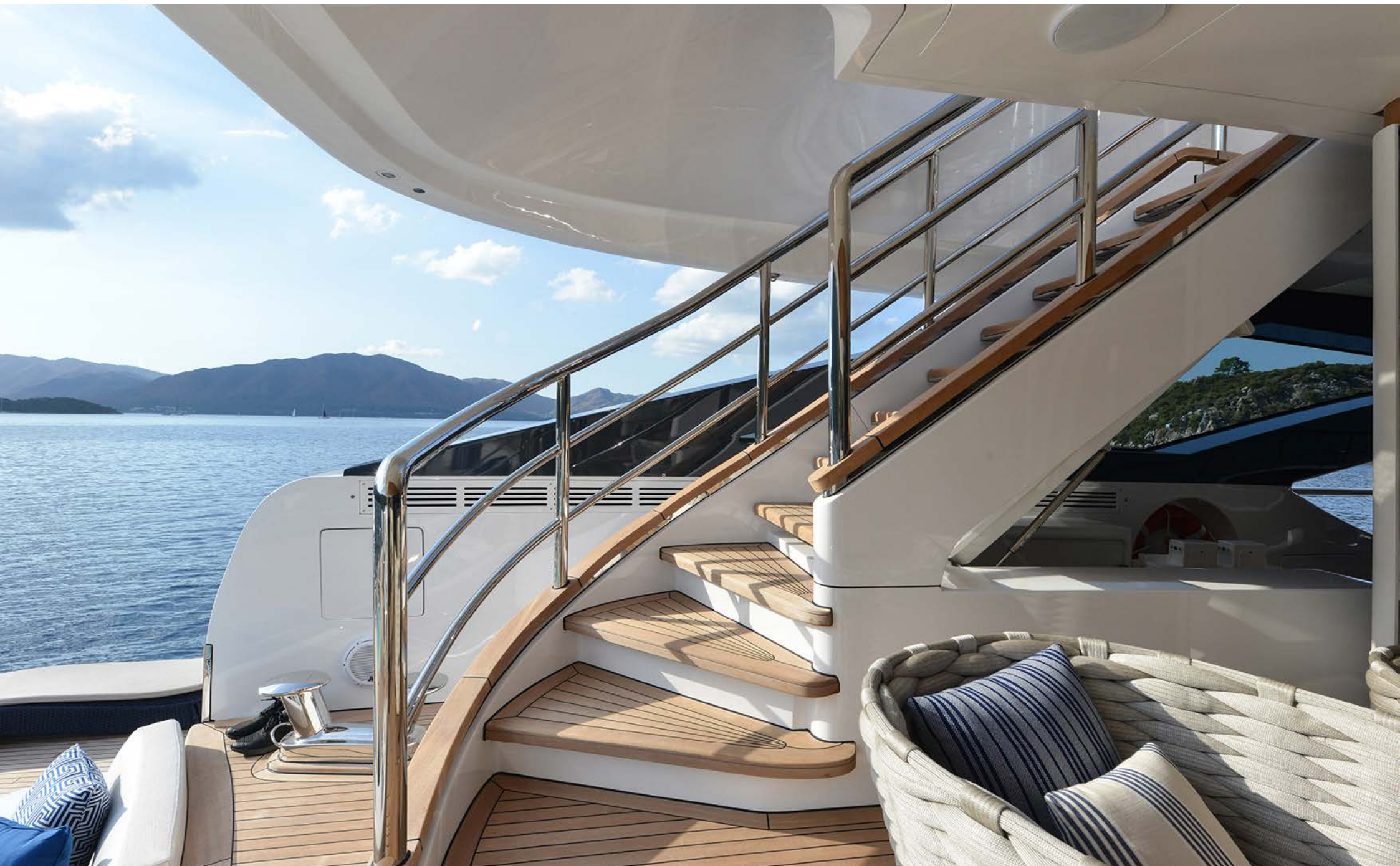

Beach Club



Beach Club



Beach Club



Beach Club



Beach Club



Owner's Cabin



Owner's Cabin



Owner's Cabin



Owner's Cabin



Owner's Cabin



Owner's Cabin



Owner's Balcony



VIP Cabin



VIP Cabin



VIP Cabin



VIP Cabin



VIP Cabin



VIP Cabin



VIP Cabin



VIP Cabin



VIP Cabin



VIP Cabin



VIP Cabin



VIP Cabin



VIP Cabin



VIP Cabin



Guest Lobby



Guest Lobby



Guest Cabin



Guest Cabin



Galley



Galley



Layout

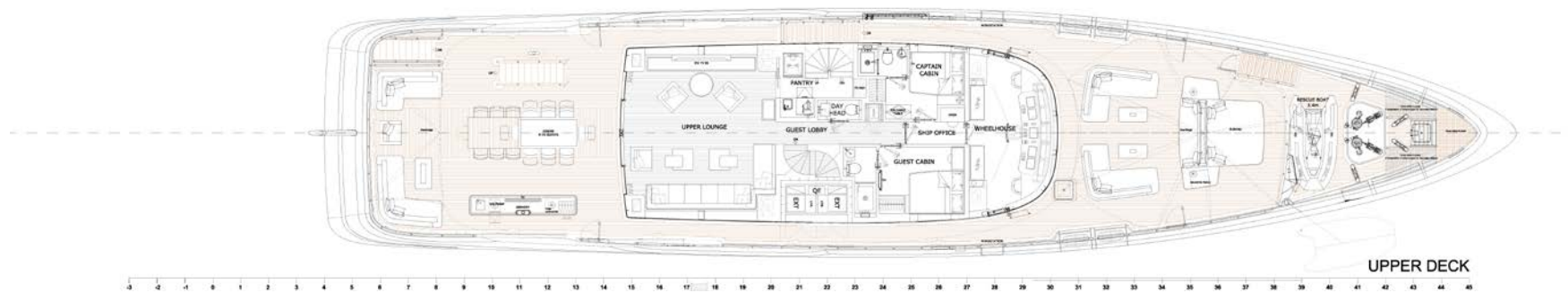
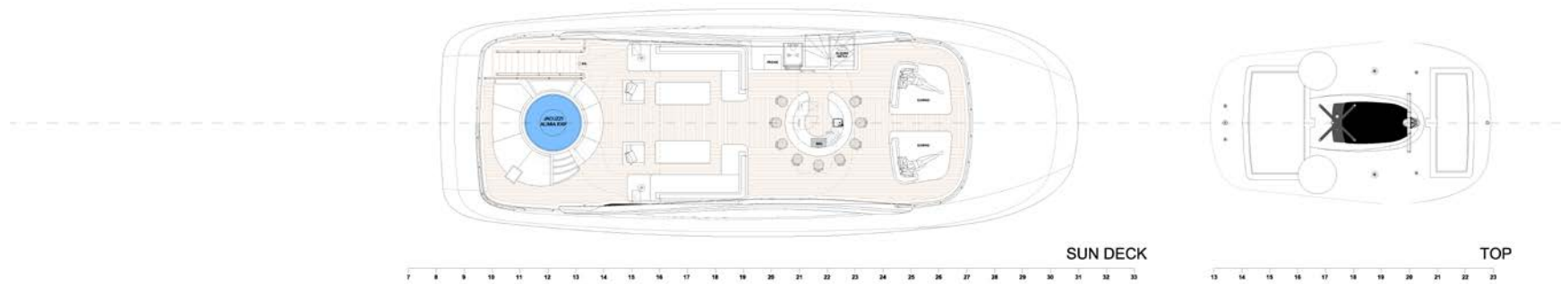

Layout

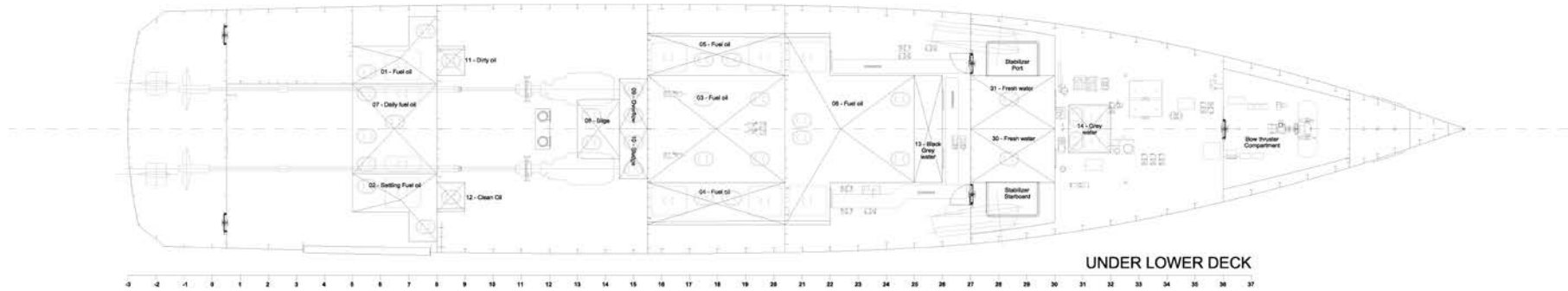
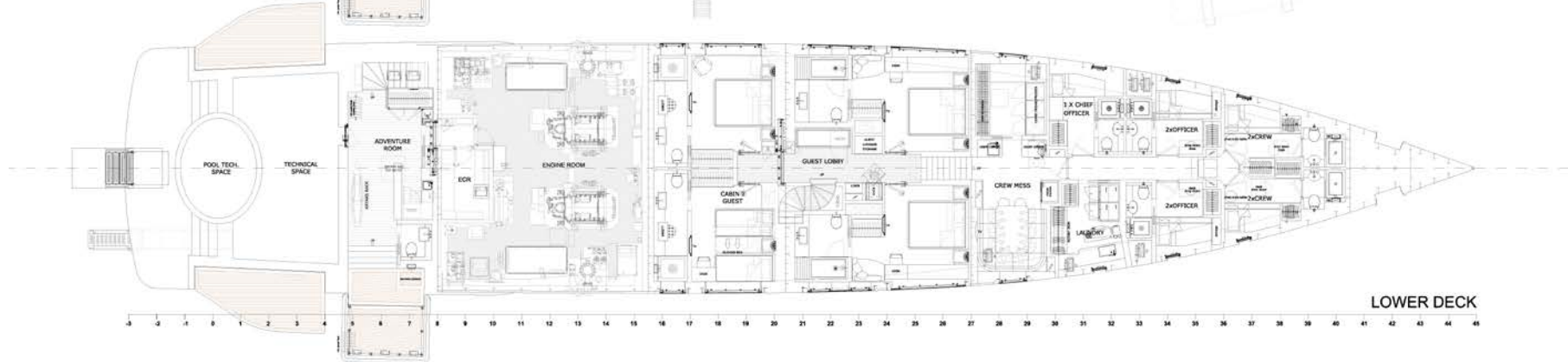
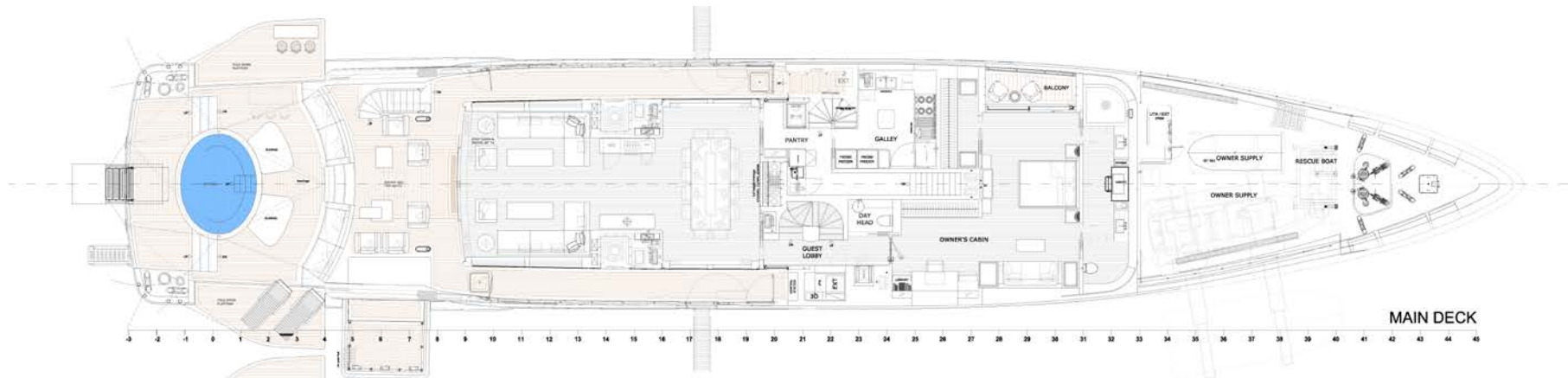

Specs

TECHNICAL FEATURES

- **CONSTRUCTION MATERIAL:** STEEL/ALUMINIUM
- **LENGTH OVERALL (LOA):** 49.90M / 163' 9"
- **MAXIMUM BEAM:** 9.00M / 30' 2"
- **MAXIMUM DRAFT:** 2.60M / 8' 6"
- **GROSS TONNAGE:** 499GT
- **FUEL CAPACITY:** 60,000L / 15,850US GALS
- **FRESH WATER CAPACITY:** 12,000L / 3,170US GALS
- **MAIN ENGINES:** 2 X MAN V12 1.400 - 1.029KW @ 2.300RPM EACH
- **MAX SPEED:** 15KNOTS
- **CLASSIFICATION:** R.I.N.A
- **CLASSIFICATION:** R.I.N.A
- **RANGE:** @12KNOTS 4.500NAUTICAL MILES
- **GENERATORS:** 2 X KOHLER 118KW 50HZ

Specs

TECHNICAL FEATURES

- **BOW THRUSTER:** 1 X ELECTRIC MOTOR DRIVEN, 110KW
- **STABILIZERS:** ONE PAIR OF ELECTRICAL, UNDERWAY AND AT ANCHOR STABILIZERS
- **PROPELLERS:** TWO FIVE FIXED BLADES PROPELLERS, NICHEL -ALLUMINIUM – BRONZE
- **NAVAL ARCHITECTURE:** P.L.A.N.A. DESIGN & AZIMUT-BENETTI S.P.A.
- **EXTERIOR STYLING & CONCEPT:** RWD
- **INTERIOR DESIGN:** BENETTI INTERIOR STYLE DEPARTMENT
- **ACCOMODATION FOR OWNER & GUEST:** 12 PERSONS, 6 CABINS
- **ACCOMODATION FOR CREW:** 10 PERSONS 6 CABINS

Specs

EXTRAS

- Flush sills between MD salon and external area
- Additional Jacuzzi on SD aft with sunbathing area
- Full Reg Code compliance (for commercial use)
- Frequency converter (125 KVA)
- Glending
- 34 UW lights (all around the Yacht)
- Lower Deck Twin cabins Pullmen beds
- Lower Deck Twin cabins Sliding beds
- VS at antenna (Sailor V sat V9000)
- TV HD TV sat antenna (Seatel 100 TV HD)
- Oval pool on aft
- Additional aft starboard shell door, Weathertight hatchway to access the adv room, Additional stainless-steel carpentry, Engineering costs
- Bollard on upper side for parking in bay
- Transformer on beach platform
- Upper Deck cabin upgrade

Specs

EXTRAS

- USB socket on bed side tables (12)
- Removable steps between the 2 aft platforms
- Awning on Upper Deck aft and forward, Main Deck aft
- Water maker: Idromar MC-9 duplex system (18000 / day)
- 2x Wine Cellar (Sun Deck bar + Upper Deck aft Bar, leaving the allowance untouched)
- Upper Deck Lounge fixed 85" TV
- Bar with domestic appliances in adventure room
- Upper Deck fwd.: Drawer fridge under the sun pad sides table
- Side platform: nr2 additional folding cleats (4 in total)
- Side platform: shower corner (additional fresh water line, teak grating floor, shower and mixer)
- Aft pool sun pads loose cushions
- Additional CCTV camera for the fwd. Upper Deck and side corridors
- Upgrades to wood floor in: Master cabin, Lower Deck lobby, foyer, staircase, Upper Deck lobby, Main Deck Saloon and Upper Deck Saloon
- 1 additional steam oven
- Removable, custom-made manual swimming ladder

Disclaimer

All speeds, measurements, capacities, consumptions, etc. may be approximate or estimated. Specifications provided for information only. Data was obtained from sources believed to be reliable and is not guaranteed by owner or brokers. Buyer assumes the responsibility to ascertain the correctness of all data contained herein and otherwise provided and must instruct his agent and surveyors to confirm all details for accuracy prior to purchase. Subject to prior sale, price and inventory change, or withdrawal from market without notice.



Benetti

ATLANTIS
COLLECTION

MAGELLANO
COLLECTION

FLYBRIDGE
COLLECTION

S
COLLECTION

Grande
COLLECTION

For more information please contact: Niso Gado
+972-50-7644438 | niso@azimutyachts.co.il | www.azimutyachts.co.il
